

LA SERIES - BENCHTOP FUME HOOD



Customer Name: _____

Indicate Color: _____

Indicate Qty: _____

Work Order #: _____

Light Switch Blower Switch Blank Cover Plate Alarm *(Circle One)*

Indicate Plumbing Service - if none, leave blank _____

Indicate Plumbing Service - if none, leave blank _____

Indicate Plumbing Service - if none, leave blank _____

Indicate Plumbing Service - if none, leave blank _____

Blank GFI Duplex GFI Simplex Std Duplex Std Simplex *(Circle One)*

Light Switch Blower Switch Blank Cover Plate Alarm *(Circle One)*

Indicate Plumbing Service - if none, leave blank _____

Indicate Plumbing Service - if none, leave blank _____

Indicate Plumbing Service - if none, leave blank _____

Indicate Plumbing Service - if none, leave blank _____

Blank GFI Duplex GFI Simplex Std Duplex Std Simplex *(Circle One)*

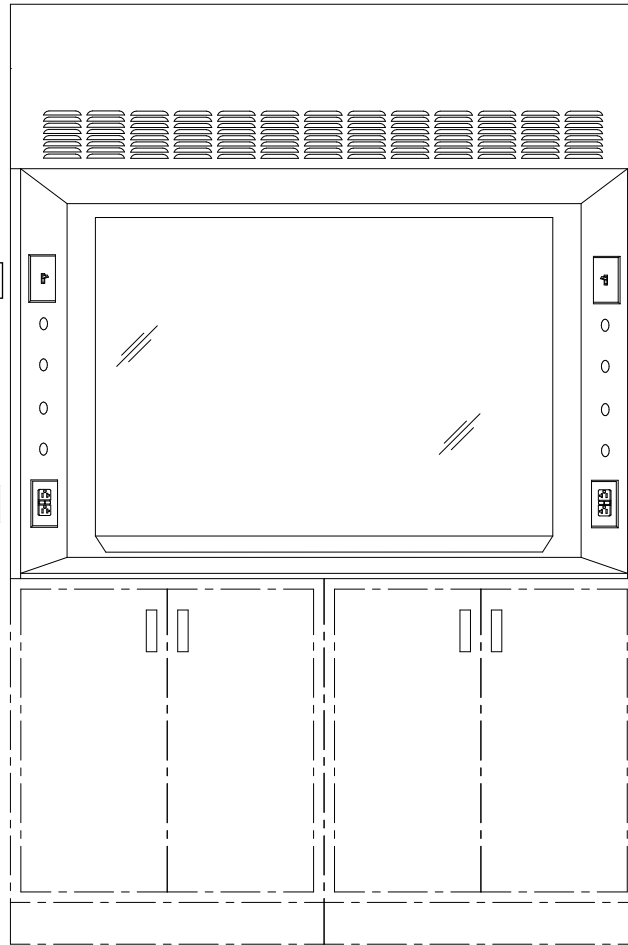

LENGTH (CHOOSE ONE)

- 36" 48" 60" 72" 96"

INTERIOR LINER OPTIONS

POLYRESIN (STANDARD)

STAINLESS STEEL T304

FIXED BAFFLE (NON STANDARD)

PLUMBING PRE-PIPING

PRE-PIPE DOWN

PRE-PIPE UP

LIGHTING OPTIONS

LED (STANDARD)

EXPLOSION PROOF LIGHT

CABINET OPTIONS

ACID

FLAMMABLE

HOOD BASE

SINK BASE

ADDITIONAL OPTIONS

ADA FRONT POST CONFIG

CEILING ENCL. (height____")

SASH STOPS

CORROSION RESISTANT HARDWARE

SASH CONFIGURATION

VERTICAL SASH (STANDARD)

HORIZONTAL SASH

COMBINATION SASH

INTERLOCKING SASH

ALARM & CONTROLLER OPTIONS

AFA 500 AIRFLOW MONITOR

AFA 1000 AIRFLOW MONITOR W/DIGITAL DISPLAY

AFA 4000/2 VAV CONTROLLER

SASH ALARM